

МОСТИ ТА ТУНЕЛІ: ТЕОРІЯ, ДОСЛІДЖЕННЯ, ПРАКТИКА

UDC 628.4.047:502.36

A. GALINSKYI¹, A. MENEYLYUK^{2*}, A. PETROVSKYI³

¹ Research Institute of building production, Lobanovskogo prosp., 51, Kyiv, Ukraine, 03037, e-mail agalin@ukr.net, ORCID 0000-0003-3648-4572

^{2*} Odessa State Academy of Civil Engineering and Architecture, Didrihsona str., 4, Odessa, Ukraine, 65029, tel. +38 (048) 723 61 51, e-mail pr.mai@mail.ru, ORCID 0000-0002-1007-309X

³ Odessa State Academy of Civil Engineering and Architecture, Didrihsona str., 4, Odessa, Ukraine, 65029, e-mail san-one@te.net.ua

ECOLOGICAL AND ECONOMIC EFFICIENCY OF THE HORIZONTAL IMPERVIOUS SCREEN FOR LOCALIZATION OF TOXIC AND RADIOACTIVE WASTE

Purpose. The definition of the ecological and economic impact and efficient use of the horizontal impervious screen in dependence on the depth of location of the impermeable soil layer. **Methodology.** Synthesis, analysis, mathematical methods. The technique of definition of harm size caused by pollution and clogging of land resources through violation of environmental legislation, developed by the Ministry of environmental protection and nuclear safety of Ukraine. **Findings.** The initial date for definition of harm size caused by pollution and clogging of land resources after horizontal impervious screen arrangement is selected. The disadvantages of governmental technique are found and the method of improvement is developed. **Originality.** The governmental technique of definition of harm size caused by pollution and clogging of land resources was improved. **Practical value.** There was made environmental effect assessment of HIS adoption in water permeable soils combined with imperfect impervious diaphragm (ID), carried out by means of “diaphragm wall” in case of natural waterproof layer of soil absence Also the ecological-economic effective application of HIS compared with perfect ID buried into a natural waterproof layer of soil was determined.

Keywords: horizontal screen; impervious diaphragm; “wall in the ground”; ecological-economic impact; application area

Introduction

Environmental safety of soils and groundwater's has become particularly relevant due to objective necessity related to the growth of harmful influence of human activity on the environment.

Need to ensure environmental protection of underground space is also associated with the Kyoto Protocol, signed by majority of large industrial countries, including Ukraine. Ukrainian legislation provides general requirements to environmental safety, including construction of underground facilities, where a special place is occupied by toxic and radioactive waste storages.

In case of violating hygienic requirements for disposal and destruction of toxic industrial wastes at temporary storage sites, soils might be polluted, which in chain may contribute to migration of toxic chemicals coming into contact with medium soil, into groundwater, underground and surface water basins.

Accident at the Chernobyl nuclear power plant resulted in contamination over 4,6 million. Ha of soil with radionuclide's including 3,1 million Ha of arable land.

Should be separately noted pollution of soil and groundwater as a result of infiltration of atmospheric precipitations through buried storages of radioactive waste (RW), which were spontaneously created on the territory of Chernobyl nuclear power plant when eliminating consequences of the accident. In these vaults there were buried remains of machinery, equipment, construction materials, animals and other things having come under ionizing radiation, at the same time proper waterproofing of these storage facilities generally has not been performed.

Analyzing possibility of soil contamination with various chemicals, elements should be divided into two groups: – The first group comprises substances and their compounds insoluble in water

МОСТИ ТА ТУНЕЛІ: ТЕОРІЯ, ДОСЛІДЖЕННЯ, ПРАКТИКА

and therefore their penetration depth into soil is rather insignificant and does not exceed 2...3 m; - the second group – chemicals soluble in water and radionuclide's, which by means of infiltration may penetrate to considerable depths, contaminating soils and aquifers. Penetration depth and contaminated water filtration speed depends on the filtration properties of soils and barrier to spreading such contamination, in this case, may be natural impermeable soil layers, for example of clay.

Actuality of soil and aquifer protection from contamination with technogenic effluents of industrial enterprises and radionuclide's increases every day. Equally important is localization of already contaminated lithosphere and preventing toxic spread both in a horizontal sense and at the significant depth.

Analysis of recent research and publications

Preventing contamination proliferation at large territory and localization of contaminated soils and

groundwater's is possible by constructing impervious diaphragm (ID) in the perimeter of contamination source, for example, "wall in the ground", to cut the ground aquifers, [1]. The effectiveness of such curtain is determined by the presence of waterproof layer of soil at a technically attainable depth.

If the waterproof layer of soil is missing or is technically inaccessible, or installing cutoff device to a considerable depth it is not economically feasible, there is a need in the artificial creation waterproof layer, for example, horizontal impervious screen (HIS) (Fig. 1) [2,3].

The analysis of the works Smorodinov M. I., Filatova A. L., Zubkov V. M., Kruglikova N. N. Chernukhina A. M., studies in NIOSP im. Gershevanov N. M. (Moscow), NIISP (Kiev), showed the need to improve methods of locating contaminated soil and groundwater in the absence of the reachable depth of the impermeable layer [4, 5, 6].

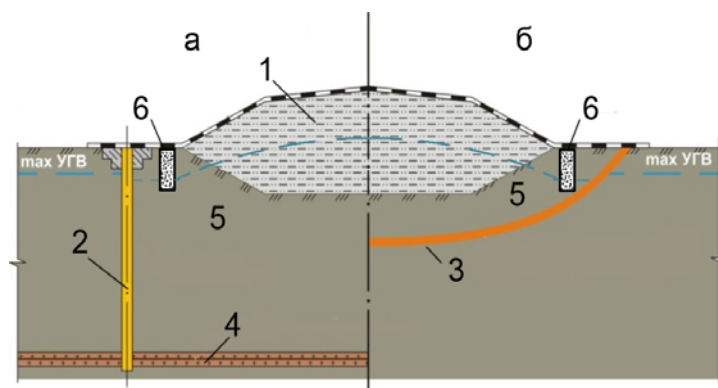

Fig. 1. Scheme of protection of soil and groundwater against contamination:
a – at presence of waterproof layer; *b* – at absence of waterproof layer; 1 – storage; 2 – GWC; 3 – HIS – artificial waterproof layer; 4 natural waterproof layer; 5 – contaminated soil; 6 – drainage

Link: developed by the authors

Unsolved aspects of the problem

Technology of impervious curtain construction (GWC) made by method of "wall in the ground" includes development of a vertical trench (cavity) protected by clay mud as a rule plunged in the waterproof layer at depth of 1...2 m, and filling of the trench with watertight material.

New construction technology of horizontal impervious screen (HIS) is based on the known method of horizontal directional drilling (HDD), and includes location of two parallel guiding horizontal wells protected by clay mud in the plane authentic to base of the facility, soil excavation

between the holes is made by relevant body to form a cavity and further filling this cavity with impervious material (IM) [7, 8].

Technologies of construction of ID and HIS have a number of common features: environmental protection, application of clay solutions to hold the trench walls from collapse, formation of cavities (vertical and horizontal) and their subsequent filling with impervious material.

However, scope of the technologies significantly varies due to the fact that the new HIS construction technique can be applied to a depth of 5m from the surface, while the depth of ID construction by "wall in the ground" method may reach

МОСТИ ТА ТУНЕЛІ: ТЕОРІЯ, ДОСЛІДЖЕННЯ, ПРАКТИКА

depths of over 100m., depending on the equipment used.

Application of the above technologies could provide equal environmental effect localizing equal areas to prevent spread of soil and ground-water contamination, but volume of contaminated soil and, accordingly, comparative economic effect determined by lithosphere treatment (recovery) cost will be different.

Thus, for territories equal in area, level of soil contamination with water soluble toxic substances and/or radionuclide's, for HIS technology will be determined by the depth of the artificial waterproof layer (5m), and for the ID, "wall in the ground", hypothetically, in case of water permeable soil, by natural impermeable soil layer depth.

Other words, ecological and economic effect of creating an artificial waterproof layer by constructing HIS is to reduce the amount of polluted soil subject to further recovery.

Purpose

The definition of the ecological and economic impact and efficient use of the horizontal impervious screen in dependence on the depth of location of the impermeable soil layer.

Methods

To estimate the ecological and economic benefits from the construction of HIS, compared with the construction of ID as "diaphragm wall" it is necessary to determine initial data to calculate both options (Figure 2.3) Provided that:

- contamination source – buried storage of toxic and/or radioactive waste located in sandy (sandy loam) soils 1-2 class of excavation difficulty;

- storage dimensions: length – 50 m, width – 46 m, underground part of storage recessed by 3 m;

Variant I (Fig. 2, a.):

- HIS is performed in accordance with technological map [9] at a depth of 5 m from the ground (2 m from the base of the vault). Screen material – clay-cement-sand mortar. Waterproof layer of soil at attainable depths is absent;

- to create closed loop and to prevent filtration on both sides of the screen at a distance of 2 m from the storage imperfect ID "wall in the ground" is arranged 1m below HIS. ID material is clay-cement-sand paste, possibly contaminated area (localization area) – 5000 m².

Variant II (Fig. 2, b):

- HIS is performed under Var. 1;

- to create closed loop, prevent filtration, reduce possible contamination area (territory of localization) imperfect ID "wall in the ground" is constructed at the perimeter of the storage at a distance of 2 meters from its boundaries 1m below HIS, possibly contaminated area (localization area) – 2,700 m².

Variant III (Fig. 3):

- along the perimeter of storage at a distance of 2 meters from its borders is arranged perfect ID "wall in the ground" recessed in the waterproof layer of soil at 1 meter. Material of curtain - clay and sand-cement paste, waterproof layer soil – Clay of 3 excavation difficulty class, possibly contaminated area (localization area) – 2700 m².

To estimate cost of implementing new construction technology HIS there were used regulatory estimates of labor and material resources, defined on the basis of technological map [9, 10].

Construction of IDs by "wall in the ground" method is widely displayed in regulatory framework of Ukraine and, therefore, to estimate cost there were used existing resource elemental estimate standards that display corresponding process.

Results

Technical and economic indicators of the implementation of above options are shown in Tab. 1. Moreover in Tab. 1 for comparison are provided indicators of ID construction variants at depth 10, 15, 20 and 25 m with a natural waterproof layer of soil at depth of 9, 14, 19 and 24 m and corresponding possible contamination area (localization area).

Fig. 4 shows a plot of the specific cost of localization for equal areas (ratio of ID cost to localization area) depending on the depth of the natural waterproof layer of soil in comparison with localization cost of the contaminated soil without waterproof layer of soil using HIS technology combined with imperfect ID.

At equal localization areas, comparing construction cost of HIS combined with imperfect ID with depth of 6 meters and construction of a perfect ID discovers effectiveness of building artificial waterproof layer of soil under the condition of natural aquitard presence at depths exceeding 13 m.

As mentioned above area of contamination can not characterize environmental damage caused by contact of toxic radionuclide's with the ground,

МОСТИ ТА ТУНЕЛІ: ТЕОРІЯ, ДОСЛІДЖЕННЯ, ПРАКТИКА

since such loss is estimated by cost of treatment (recovery) of the whole soil volume which is depending to a large extent on the depth of penetration of contaminants.

Defining the counter of possible soil contamination volumes and corresponding damage includ-

ing localization cost, we can estimate ecological and economic effect of preventing spread of pollutants, using HIS combined with imperfect ID with depth of 6 m, compared with the construction of a perfect ID.

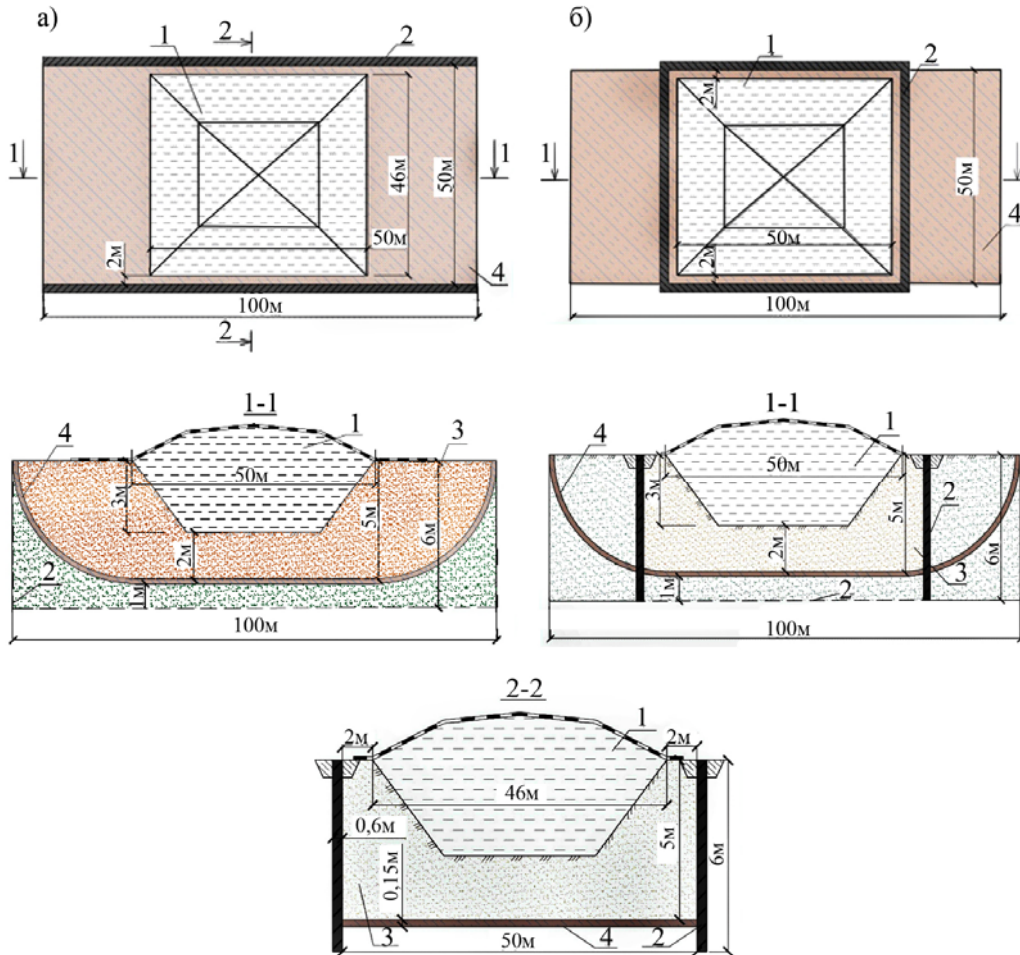

Fig. 2. Localization variant for storage without waterproof layer of soil:

a) – curtain at both sides of the screen; b) – a curtain along the perimeter of storage 1 – storage; 2 – imperfect ID; 3 – contaminated soil; 4 – HIS – artificial waterproof layer of soil

Link: developed by the authors

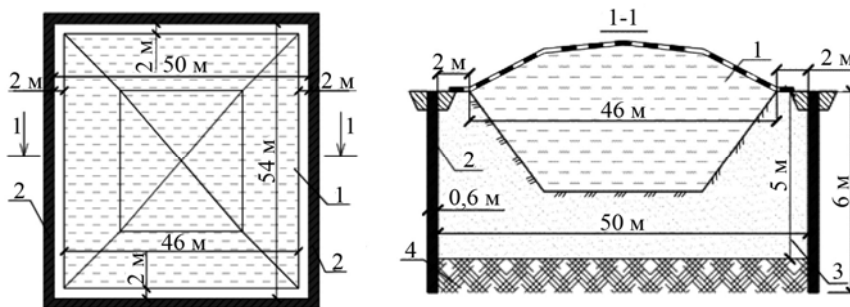

Fig. 3. Localization variant for storage with an waterproof layer of soil:

1 – storage; 2 – perfect ID; 3 – polluted soil; 4 – natural waterproof layer of soil

Link: developed by the authors

Table 1

Technical and economic indicators of pollution localization variants

Localization variant	Kinds of works	Natural waterproof layer		Screen / diaphragm depth, m	Screen / diaphragm area, m ²	Screen / diaphragm volume, m ³	Localization cost, million UAH	Localization area, m ²	Specific cost of localization thousand UAH / m ²	Volume of localized soils subject to treatment, m ³
		Availability	Depth, m							
I	HIS	-	-	5	5000	750	21,65	5000	4,33	19250
	ID			6	1200	720				
II	HIS	-	-	5	5000	750	21,96	2700	8,13	13500
	ID			6	1248	749				
III	ID	+	5	6	1248	749	10,45	2700	3,87	13500
IV	ID	+	9	10	2080	1248	15,92	2700	5,90	24300
V	ID	+	14	15	3120	1870	22,76	2700	8,43	37800
VI	ID	+	19	20	4160	2496	29,61	2700	11,97	51300
VII	ID	+	24	25	5200	3120	36,45	2700	13,50	64800

Link: developed by the authors

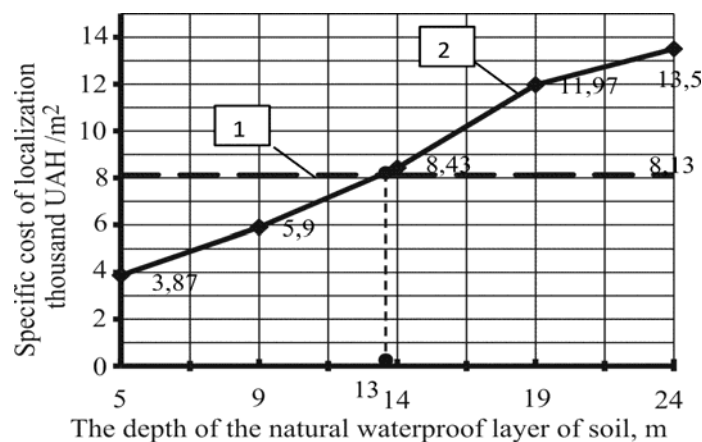

Fig. 4. Graph of the specific localization cost depending on the depth of the waterproof layer of soil:

1 – HIS combined with ID without the natural waterproof layer; 2 – ID at presence of natural waterproof layer of soil

Link: developed by the authors

According to the “Methodology ...” [11] amount of damage from land pollution is determined by the formula (1):

$$S = A \cdot G \cdot P \cdot K_1 - K_2 - H, \quad (1)$$

where: S – size of damage caused by soil contamination (cost of soil treatment (recovery)), UAH; $A = 0,5$ – specific costs to eliminate the impact of plot pollution; $G = 94,5$ UAH/m² – normative monetary valuation of a polluted land plot. It is assumed at the level of 4.5 thousand US dollars per

1 hectare. [12]; P – area of a polluted land plot (localization area), m² (see tabl. 1.); K_1 – coefficient of land plot pollution, characterizing amount of the pollutant in the volume of contaminated land, depending on infiltration depth; $K_2 = 4,0$ – hazard ratio of the pollutant. Assumed according to [11], Appendix 1 “extremely dangerous”; $H = 0,2$ – ecological and economic purpose of land scale indicator. Assumed according to [11, Appendix 2] “industrial land, transport, communications, ener-

МОСТИ ТА ТУНЕЛІ: ТЕОРІЯ, ДОСЛІДЖЕННЯ, ПРАКТИКА

gy, defense"; K_1 – pollution coefficient of a land plot calculated according to the formula (2):

$$K_1 = \frac{O}{T} \cdot P \cdot l_n, \quad (2)$$

where: O – the amount of the pollutant, m^3 . Accepted conditionally on the level of 1 % of the volume of localized (polluted) soil; $T = 0,2$ m – thickness of earth layer, which is dimensional unit to calculate remediation costs, depending on the infiltration depth [11]; l_n – correcting index to

expenses for liquidation of pollution, depending on pollutant infiltration depth.

According to [11] l_n is calculated only to the depth of infiltration 2m (Tab. 2). In this case, specified that expenditures for the implementation of activities to reduce or eliminate land pollution increases depending on the depth of pollutant infiltration in the ratio of 10 : 3. I.e. as depth increases of 10 times thicker than land at 0,2 m costs for the pollution elimination increase 3 times.

Table 2

Correction indexes to expenses (l_n)

Infiltration depth	l_n	Infiltration depth	l_n
0...0,2	0,100	0...1,2	0,049
0...0,4	0,082	0...1,4	0,044
0...0,6	0,070	0...1,6	0,040
0...0,8	0,060	0...1,8	0,037
0...1,0	0,054	0...2,0	0,033

Link: [11]

Analyzing the graph of the exponential approximation of the data in Table 2 (Fig. 5), it can be argued that at considerable depths infiltration Index of corrections to cost IP approximates to values close to zero.

According to the schedule, to calculate coefficient of pollution for a land plot K_3 regarding infiltration depth: 0...5 m l_n Index of corrections to costs is accepted 0,006 for depths of 0...10 m – 0,0012, for the depths of 0...15 – 0,0005, and for infiltration depth more than 15 m – 0,0001.

Calculations discovered possibility of significant reducing volume of soil pollution with radionuclide's or toxic waste and, accordingly, a significant reduction in its recovery cost in case of using HIS localization variants (Tab. 3).

The graph in Fig. 6 shows efficiency of HIS construction combined with imperfect ID of 6m depth, compared with the construction of a perfect ID as a part of complex activities on liquidation of consequences of soil pollution in case of natural waterproof layer of soil is present at depths of more than 6,5...8 m.

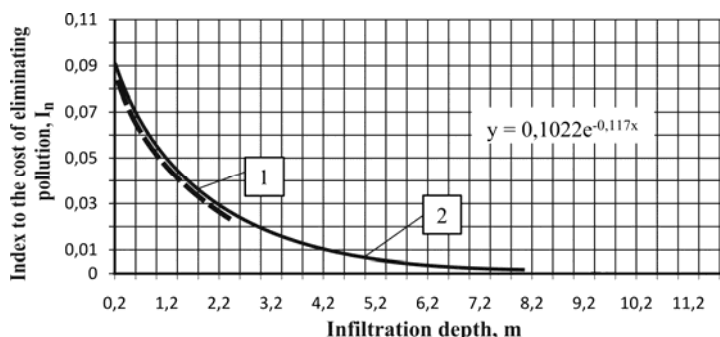

Fig. 5. Graph of dependence l_n of Infiltration depth contaminated water:

1 – curve according to the tab. 2; 2 – approximated curve

Link: developed by the authors

Technical and economic indicators of soil pollution liquidation variants

Localization variant	Kinds of works	Screen / diaphragm depth, m	Natural waterproof layer of soil depth, m	Localization area, m ²	Volume of localized soils subject to treatment, m ³	Localization cost, million UAH	Pollutant volume, m ³	Treatment costs, million UAH	Liquidation of pollution consequences, million UAH	Specific expenses for the elimination thousand UAH/m ³
I	HIS	5	—	5000	19250	21,65	192,5	6,06	27,71	1,45
	ID	6								
II	HIS	5	—	2700	13500	21,96	135,0	4,25	26,21	1,94
	ID	6								
III	ID	6	5	2700	13500	10,45	135,0	4,25	14,70	1,09
IV	ID	10	9	2700	24300	15,92	243,0	38,27	54,19	2,23
V	ID	15	14	2700	37800	22,76	378,0	142,88	165,64	4,38
VI	ID	20	19	2700	51300	29,61	513,0	969,57	999,18	19,48
VII	ID	25	24	2700	64800	36,45	648,0	1224,72	1261,17	19,46

Link: developed by the authors

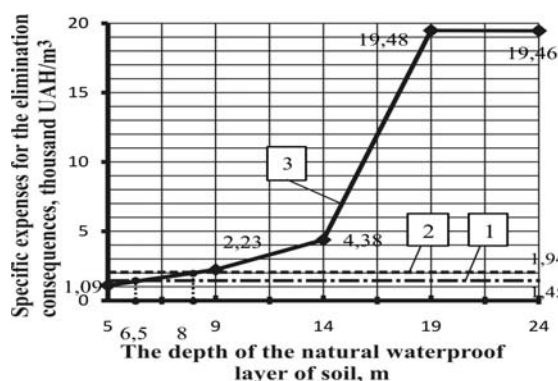

Fig. 6. Graph of the specific costs of pollution elimination against the depth of the waterproof layer of soil: 1 – HIS combined with ID along the two sides of the screen, without the natural waterproof layer (Fig. 2, a); 2 – HIS combined with ID at the perimeter of the storage without natural waterproof layer of (Fig. 2, b); 3 – ID at presence of natural waterproof layer (Fig. 3)

Link: developed by the authors

Scientific novelty

The governmental technique of definition of harm size caused by pollution and clogging of land resources was improved.

Practical importance

There was made environmental effect assessment of HIS adoption in water permeable soils combined with imperfect impervious diaphragm (ID), carried out by means of "diaphragm wall" in case of natural waterproof layer of soil absence

Also the ecological-economic effective application of HIS compared with perfect ID buried into a natural waterproof layer of soil was determined.

Conclusions

1. Comparing localization costs of land sites of equal area polluted with toxic waste or with radionuclide's, shows efficiency of building a horizontal impervious screen (artificial aquitard) at a depth of 5m combined with imperfect grout curtain of 6m depth, compared with the construction of perfect

МОСТИ ТА ТУНЕЛІ: ТЕОРІЯ, ДОСЛІДЖЕННЯ, ПРАКТИКА

curtain, if the natural waterproof layer of soil is located at depths exceeding 13 m.

2. The construction of the horizontal impervious screen (artificial waterproof layer of soil) in combination with imperfect grout curtain would greatly reduce possible volumes of soil pollution and, therefore, significantly reduce soil treatment costs (recovery).

3. Application of horizontal impervious screen (artificial a waterproof layer of soil) as part of a complex of actions on liquidation of consequences pollution of soils at a depth of 5 m combined with imperfect grout curtain of 6m depth of the shows screen efficiency in comparison with a perfect grout curtain under the condition of the natural waterproof layer of soil location at depths of more than 6,5...8 m.

4. Ecological and economic effect of the application together with a vertical screen, horizontal impervious screen, is to reduce 10 times the cost of restoring contaminated soil from 19,48 to 1,94 thousand UAH. for 1 m³.

REFERENCES

1. DSTU-N B V. 2.1-29:2014, Guidance on the design of the device is recessed structures by the method of "wall in soil" Kiev, Ministry of regional development of Ukraine, 2014. 69 p.
2. Pat. A 35065, Ukraine, E 02 D 29/00. The way to the screen under the construction / A. M. Chernukhin, A. M. Galinskiy; Appl. 05.08.1999; publ. 15.03.2001 G. bull. No. 2.
3. Pat. 95383 Ukraine to the invention, E 02 D 31/00. The way to the screen under the construction / A. M. Chernukhin., A. M Galinskiy.; Appl. 10.09.2010 ; publ. 25.07.2011, bull. No. 14
4. Trench wall in the soil / [Kruglitsky H. H., Milkovitsky S. I., Skvortsov V. S., and others]. - Kiev : Naukova Dumka, 1973. – 304 p.
5. The experience of construction by method "wall in the ground" / A. L. Filahtov, G. K. Lubenets, N. In. Picanco, etc. – Kiev : Budivel'nik, 1981. - 236 p.
6. Smorodinov M. I. foundations and structures by method of "slurry wall" / M. I. Smorodinov, B. S. Fedorov. – Ed. 2nd, Rev. and extra – Moscow : stroizdat, 1986. – 216 p.
7. Chernukhin A. M., Galinskiy, A. M., Study of cavities for the device underground of the screen under the construction / A. M. Chernukhin, A. M. Galinskiy // Scientific and technical journal "Budivel'ne virobnictvo". – Kyiv : NDIBV, 2000. – VIP. 41. – P. 37-40.
8. Galinskiy A. Research of technology of construction of horizontal impervious screen under the existing structures. Conference proceedings XV Danube – European Conference on Geotechnical Engineering (DECGE 2014) 9_11September 2014, Vienna, Austria, volume 2 Paper No.1213_1219.
9. The routing device horizontal impervious screen under existing structures using the technology of horizontal directional drilling / A. M. Galinskiy, S. A. Marchuk, A. M. Chernuhin // Routing. – Kyiv : NDIBV, 2015. – 60 p.
10. Galinskiy, A. M., Yachmenova Y. V, Tereshchenko L. V. Regulation of the process of the device of the horizontal seepage screen under existing structures with the use of technology horizontal plane drilling. Scientific and technical journal "Budivel'ne virobnictvo". Kyiv : NDIBV, 2014, №. 57(2), P. 3-6
11. The technique of definition of size of harm caused by pollution and clogging of land resources through violation of environmental legislation. The Ministry of environmental protection and nuclear safety of Ukraine. Order No. 171 dated 27.10.1997.
12. Land reform in Ukraine in the context of development of the agrarian economy and rural development. Institute of development of agrarian markets. 2013 (p. 8) http://www.amdi.org.ua/docs/broshura_1.pdf

О. М. ГАЛІНСЬКИЙ¹, О. І. МЕНЕЙЛЮК^{2*}, А. Ф. ПЕТРОВСЬКИЙ³

¹ Науково-дослідний інститут будівельного виробництва, пр. Лобановського, 51, Київ, Україна, 03037, ел. пошта agalin@ukr.net, ORCID 0000-0003-3648-4572

^{2*} Одеська державна академія будівництва і архітектури, вул. Дідріхсона, 4, Одеса, Україна, 65029, тел. +38 (048) 723 61 51, ел. пошта rg.mai@mail.ru, ORCID 0000-0002-1007-309X

³ Одеська державна академія будівництва і архітектури, вул. Дідріхсона, 4, Одеса, Україна, 65029, ел. пошта san-one@te.net.ua

ЕКОЛОГО-ЕКОНОМІЧНА ЕФЕКТИВНІСТЬ ГОРИЗОНТАЛЬНОГО ПРОТИФІЛЬТРАЦІЙНОГО ЕКРАНУ ДЛЯ ЛОКАЛІЗАЦІЇ ТОКСИЧНИХ І РАДІОАКТИВНИХ ВІДХОДІВ

МОСТИ ТА ТУНЕЛІ: ТЕОРІЯ, ДОСЛІДЖЕННЯ, ПРАКТИКА

Мета. Визначення екологічного та економічного впливу, шляхів ефективного використання горизонтальних протифільтраційних екранів в залежності від глибини залягання водоупору. **Методика.** Синтез, аналіз, математичні методи. Методика визначення шкоди від забруднення земельних ресурсів в результаті порушення природоохоронного законодавства, розроблена Міністерством захисту навколишнього середовища та радіаційної безпеки України. **Результати.** Зібрано вихідні дані для визначення розмірів шкоди, заподіяної забрудненням земельних ресурсів при влаштуванні горизонтального проти фільтраційного екрана. **Наукова новизна.** Удосконалено галузева методика визначення шкоди від забруднення земельних ресурсів в результаті порушення природоохоронного законодавства. **Практична значимість.** Визначено вплив пристрою горизонтального проти фільтраційного екрана водонепроникних ґрунтах на навколишнє середовище при його поєднанні з водонепроникною діафрагмою, спорудженої методом «стіна в ґрунті» до водоупору. Також визначено еколого-економічний ефект пристрою горизонтального проти фільтраційного екрана при його поєднанні з водонепроникною діафрагмою, заглибленою в природний водоупор.

Ключові слова: горизонтальний екран; непроникна діафрагма; «стіна в ґрунті»; еколого-економічний ефект; сфера використання

А. М. ГАЛИНСКИЙ¹, А. И. МЕНЕЙЛЮК^{2*}, А. Ф. ПЕТРОВСКИЙ³

¹ Научно-исследовательский институт строительного производства, пр. Лобановского, 51, Киев, Украина, 03037, эл. почта agalin@ukr.net, ORCID 0000-0003-3648-4572

^{2*} Одесская государственная академия строительства и архитектуры, ул. Дидрихсона, 4, Одесса, Украина, 65029, тел. +38 (048) 723 61 51, эл. почта rg.mai@mail.ru, ORCID 0000-0002-1007-309X

³ Одесская государственная академия строительства и архитектуры, ул. Дидрихсона, 4, Одесса, Украина, 65029, эл. почта san-one@te.net.ua

ЭКОЛОГО-ЭКОНОМИЧЕСКАЯ ЭФФЕКТИВНОСТЬ ГОРИЗОНТАЛЬНОГО ПРОТИВОФИЛЬТРАЦИОННОГО ЭКРАНА ДЛЯ ЛОКАЛИЗАЦИИ ТОКСИЧНЫХ И РАДИОАКТИВНЫХ ОТХОДОВ

Цель. Определение экологического и экономического влияния, путей эффективного использования горизонтальных противofильтрационных экранов в зависимости от глубины залегания водоупора. **Методика.** Синтез, анализ, математические методы. Методика определения вреда от загрязнения земляных ресурсов в результате нарушения природоохранного законодательства, разработанная Министерством защиты окружающей среды и радиационной безопасности Украины. **Результаты.** Собраны исходные данные для определения размеров вреда, причинённого загрязнением земляных ресурсов при устройстве горизонтального противofильтрационного экрана. **Научная новизна.** Усовершенствована отраслевая методика определения вреда от загрязнения земляных ресурсов в результате нарушения природоохранного законодательства. **Практическая значимость.** Определено влияние устройства горизонтального противofильтрационного экрана в водонепроницаемых ґрунтах на окружающую среду при его соединении с водонепроницаемой диафрагмой, сооружённой методом «стена в ґрунте» до водоупора. Также определён эколого-экономический эффект устройства горизонтального противofильтрационного экрана при его соединении с водонепроницаемой диафрагмой, заглобленной в природный водоупор.

Ключевые слова: горизонтальный экран; непроницаемая диафрагма; «стена в ґрунте»; эколого-экономический эффект; сфера применения

Prof. V. A. Halushko, D. Sc. (Technical, Ukraine) and Prof. V. D. Petrenko, D. Sc. (Technical, Ukraine) recommended this article to be published.

Received: December 15, 2015.

Accepted: December 21, 2015.